

Insulation either installed on top of the rafters
or in between fully filling the depth of the rafter

Ply wood or OSB boards can be used if the
insulation is installed on top of the rafters

Klober Permo[®]Sec metal Laps to be sealed using
Tacto[®]double sided tape (width 20mm)

Metal standing seam roof

Klober underlay
support tray

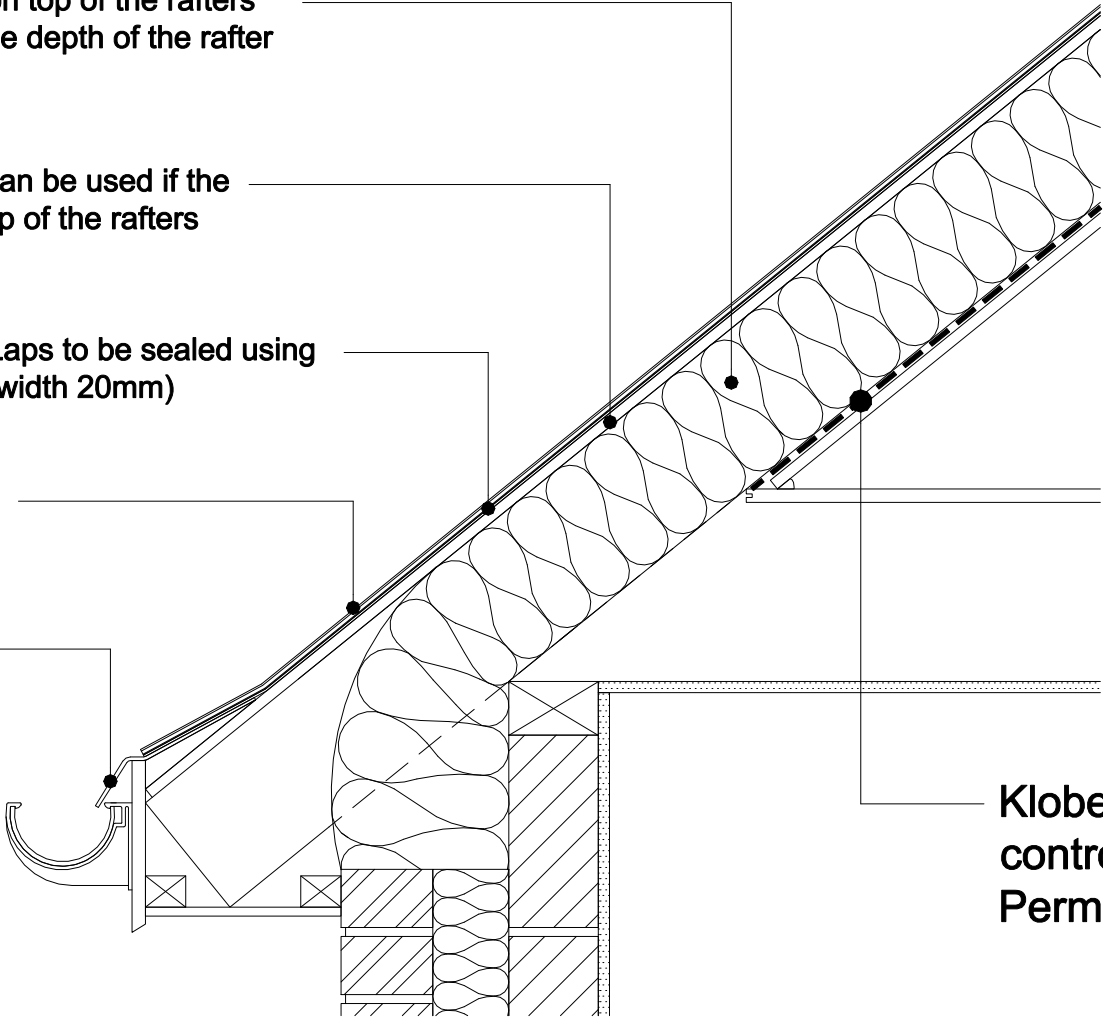

Klober Wallint[®] air barriers and vapour
control layers with lap joints sealed using
Permo[®] TR adhesive tape (width 60mm)

KLOBER
PERMO[®]SEC METAL
DRG No. KL008